

REV	ECO NO.	DATE	BY	APP'D
A	REL TO PRODUCTION PER ECO 001	1/5/06	KL	

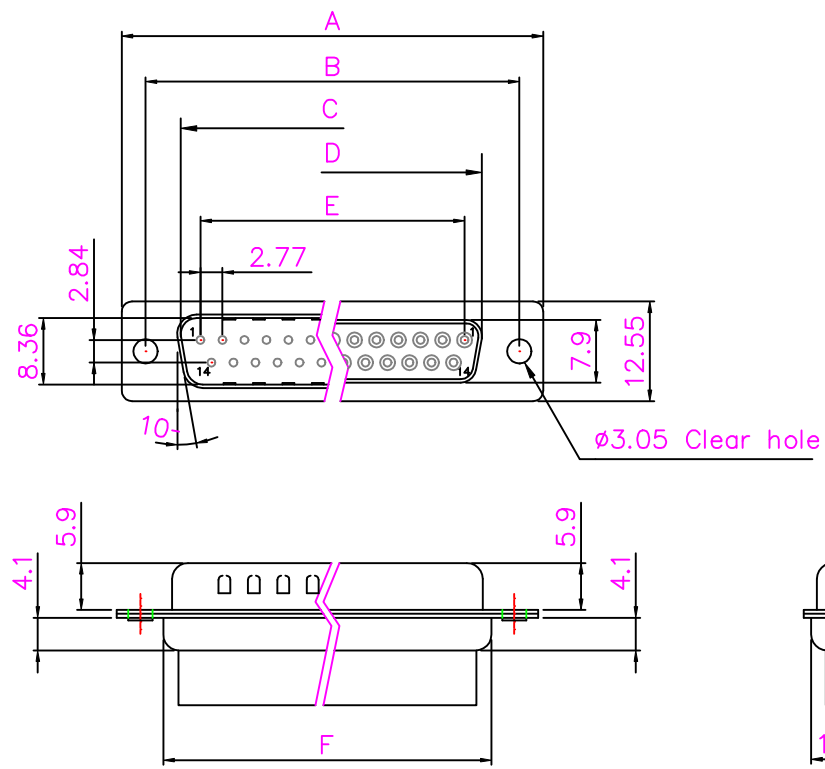

**Product Specification**

**Material**

Insulator : Glass-Filled PBT, UL94V-0  
 Shell : Steel, tin plated  
 Operating temperature: -55°C-105°C

**Electrical**

Contact Resistance : 15 milliohms Max.  
 Insulation Resistance : 1000 magohms at 500 VDC  
 Dielectric Withstanding Voltage : 1000 VAC for 1 minute  
 Current Rating : 3 AMP  
 Volatge Rating : 250 VAC/rms

**Dimensions**

Positions	A	B	C	D	E	F
9	30.81	24.99	16.92	16.33	11.08	19.20
15	39.14	33.32	25.50	24.66	19.39	27.70
25	53.04	47.04	38.96	38.38	33.24	41.10
37	69.32	63.50	55.42	54.84	49.86	57.30

Tolerance	
.x	±0.35
.xx	±0.25

UNIT: mm

CONFIDENTIAL



© Copyright 2006 Regal Electronics, Inc. This drawing is the property of Regal Electronics and contains confidential information, trade secret information and/or know-how which is the property of Regal Electronics. By accepting this drawing, the recipient agrees not to provide, or otherwise make available, the drawing or any information or know-how embodied therein, to any third party without prior written authorization.

DRAWN: KIM	DATE: 1/5/06
CHECKED:	DATE:
ENGINEER:	DATE:
APPROVED:	DATE:
APPROVED:	DATE:
APPROVED:	DATE:

TITLE: D-Subminiature Standard Crimp Connector		
SIZE: B	DRAWING NO.: R4009/R4010	REV: A
SCALE: NONE	SHEET 1 OF 1	

NOTE: This component and all homogeneous subcomponents are RoHS compliant

C-R4009/R4010